

ECO TRAP 65

ENGLISH

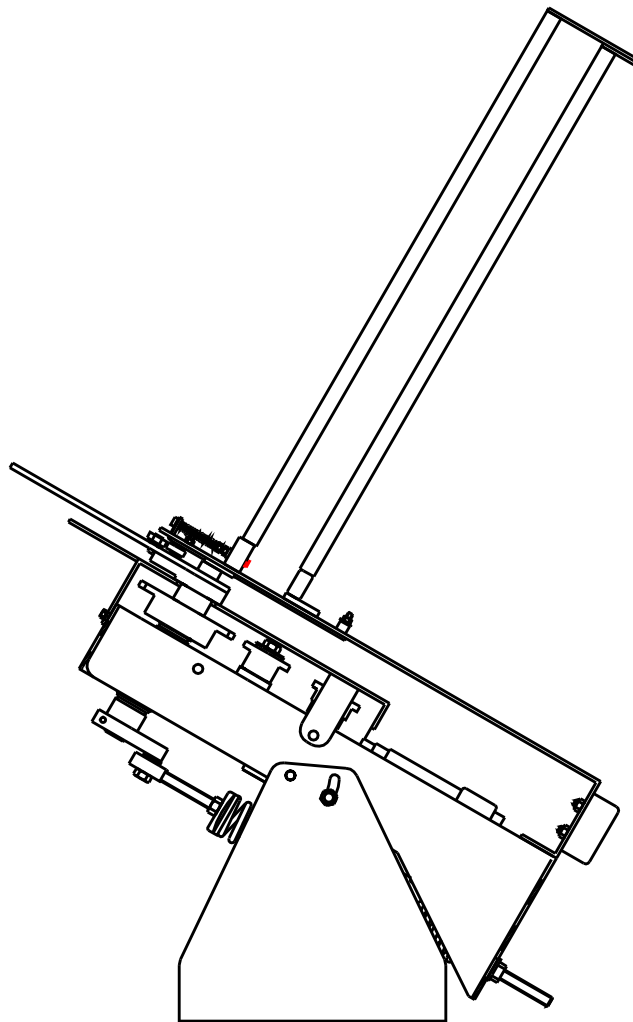

FEATURES AND DESCRIPTIONS

LAPORTE® Trap model 65 is a fully automatic trap and combines simplicity and reliability, robustness and lightness (aluminium body), trajectory regularity and rapid adjustment.

This model allow you to throw rapid and continuous clays (re-arming in 1.1 seconds) and offer the possibility to quickly change the type of clay pigeon (Standard, Battue, Mini or Midi).

SPECIFICATIONS:

- COMPANY WITH PROVEN RECORD OF SUCCESS

- 70 Years of Trap design
- Supplier to Olympic Games
- The only traps on the market endorsed by NSSA (National Skeet Sporting Association, USA), NSCA (National Sporting Clay Association, USA), FITASC (International Federation for Shooting Sport), and by appointment to Her Majesty the Queen of U.K.

- UNCOMPLICATED DESIGN

- Simple to use
- Minimum moving parts
- Easy maintenance and parts replacement

- MAGAZINE:

- 1 column
- 65 target capacity (Standard, Midi and Mini and Battue)
- Top loading

- TARGET:

- Standard with optional adapter for Midi (90 mm), Mini (60mm) or Battue.

- ALUMINIUM CASTINGS.

- High quality epoxy paint finish (does not rust)
- Lightweight, easily moved

- PRE-WIRED ELECTRICAL CONTROL BOX.

- Easily maintained electrical parts

- SAFETY

- Full safety guard for the throwing arm.

- Note: Must always be assembled on Trap

- Encircles whole area traversed by throwing arm

- ONE WAY BEARING ON THROWING ARM

- Stops the throwing arm in 3/4 armed position
- Reduces vibrations
- Enables faster 'arming'

- TRAJECTORY:

- Perfect from start to finish

- THROWING DISTANCE:

- From 20 m to 100 m (black spring – green springs)

- TRAJECTORY MOVEMENTS:

- Fixed position

- TARGET RELEASE:

- By cable.
- Or on option: by radio remote control or voice release system upon request.

- VOLTAGE: available in 12V.

- **RE-ARMING:** 1.1 seconds. The motor only operates for a short time during the re-cocking sequence and therefore, uses very little power.

- WEIGHT: 55 Kg

If you have any questions or need assistance, please call:
LAPORTE® Head Office Phone : +33 493 65 77 77 Fax : +33 493 65 77 78
e-mail export@laporte-shooting.com www.laporte-shooting.com

SAFETY FIRST

DANGER - THESE MACHINES CAN CAUSE SERIOUS INJURY!
READ INSTRUCTIONS THOROUGHLY BEFORE ATTEMPTING TO INSTALL OR OPERATE!

1. **F BEFORE:**

- q Installing the trap,
- q Connecting power,
- q Lubricating,
- q Loading the magazine or
- q Making any adjustments

F Be sure that the throwing arm is in the safe, uncocked position or that the mainspring is disconnected, the "ON-OFF-UNCOCK" toggle switch on the electrical control box is in the "OFF" position, and the machine is disconnected from the power source.

NOTE: The "Decocked" position mentioned throughout this manual refers to the position of the throwing arm.

2. All personnel required to operate the trap, or load targets into the magazine, should read this instruction manual and be trained by someone knowledgeable as to the safe operation of the equipment.

3. Do not leave trap cocked when not in use. Not only is this practice very hazardous, but, as the mainspring is stretched, its useful life will be shortened.

4. Only one person should operate the trap at any one time.

5. Do not operate the trap without the safety guard ring installed on the trap as illustrated in this manual. This safety guard defines the danger zone of the throwing arm rotation.

6. Do not lift or move the trap by the throwing arm or the safety guard. Do not lean on the safety guard or place any weight on it such as box of targets.

7. Safety glasses must be worn by all personnel within close proximity to the trap to prevent eye injury from flying target fragments.

8. Always keep children and animals away from the trap machine.

9. Before turning on any switches, move to a safe position at the left rear of the trap and make sure that no one is within the danger zone in front of the trap. High-speed fragments from broken targets being thrown may fly outside the normal target danger zone, even backwards. (They may even rebound off traphouse sides etc.). When trap is cocked and ready for use, always leave the area by keeping to the rear of the machine.

10. Before approaching the trap, for any maintenance, adjustments, or for the loading of targets, be sure the trap is turned off with the "ON-OFF-UNCOCK" toggle switch on the electrical control box in the "OFF" position, and the throwing arm is in the "Decocked" 8:45 position.

NOTE: TO DECOCK THE THROWING ARM AND PLACE THE TRAP IN A SAFE CONDITION, MOVE THE "ON-OFF-UNCOCK" TOGGLE SWITCH, ON THE ELECTRICAL CONTROL BOX, TO THE "UNCOCK" POSITION, THEN TO THE "OFF" POSITION. THE THROWING ARM SHOULD 'FIRE' AND STOP IN THE "UNCOCKED" POSITION OUT IN FRONT OF THE TRAP. THEN DISCONNECT POWER FROM THE ELECTRICAL CONTROL BOX.

START-UP INSTRUCTIONS

This trap may be installed on LAPORTE trolley or a wooden or concrete platform.
Secure the trap to the base using suitable screws and bolts for the type of platform being used.

1. Install the spring (see Arming Spring notice)

2. Install the Safety Guard for the throwing arm (see notice).

3. Install the standard clay magazine (see notice):

4. Insert a pile of clays from the top of the magazine and make sure that the bottom clay is situated correctly on the clay holding mechanism.

5. Connect the "Pull Cord".

Plug the white 4-pin plug of the cable release onto the female plug on the moulded box and latch the clip to hold this in position.

6. Electrical connection (see notice):

Control the polarities "+" and "-" on the power supply.

7. IMPORTANT: Before any subsequent manipulations, stand behind the machine in the "safety position" and make sure that no-one is standing in the "firing zone".

8. Position the "ON-OFF-UNCOCK" switch from the **OFF** position to the **ON** position.

Press once on the "PULL"

- A clay falls and the arm cocks. Press a second time to fire and re-cock the machine.

Repeat this last operation a few times in order to establish the correct distance and trajectory.

9. Unarm the machine with a clay.

Before any modification:

Move the switch marked "ON-OFF-UNCOCK" on the electrical control box from the "ON" position to the "UNCOCK" position and then to the "OFF" position (Decocking the trap).

10. The start-up procedure is now complete.

11. The test procedure is now complete.

TROUBLE SHOOTING

CAUTION: BEFORE MAKING ANY CHANGES OR ADJUSTMENTS MAKE SURE THE THROWING ARM IS IN THE SAFE UNCOCKED POSITION.

1. THE COCKING MOTOR WILL NOT START

Electricity is not connected.

The circuit breaker is off or the fuse has blown. Move the switch marked "ON-OFF-UNCOCK" on the electrical control box to the "OFF" position. Remove the cover of the control box and see if the BLACK button on the circuit breaker has "Popped". If it has, press it in. Check the fuses. If the circuit breaker continues to "kick out", or if fuses continue to blow, check all wiring and electrical supply to locate the cause before continuing.

Electrical connections are dirty or loose.

The cocking motor has burnt out.

The electrical connections do not comply (see Start-Up Instructions).

2. THE MACHINE IS COCKED BUT DOES NOT FIRE

The main spring is broken.

There is no electrical supply.

The "Pull" switch or remote release system is not working.

The battery in the Optional Radio Control transmitter is flat or exhausted, and needs replacing.

The switch on the "ON-OFF-UNCOCK" is in the OFF position.

The throwing arm is blocked by two clays or by fragmented clays. **WARNING:** At this time the throwing arm will be pressing against the targets with TREMENDOUS PRESSURE. When uncocking the trap using "Manually Uncocking", be EXTREMELY CAUTIOUS, as the throwing arm will release VERY fast. The target(s) on the throwing plate will most probably shatter throwing target fragments in all directions.

The throwing arm is bent or broken and subsequently jammed against some part of the trap, e.g. the mobile throwing plate, the magazine base. **THIS IS A VERY DANGEROUS CONDITION!** As you cannot "re-arm" the machine. The arm will have to be removed.... Call LAPORTE for help.

3. THE THROWING ARM DOES NOT STOP DECOCKING AND THROWING TARGETS.

The cocking micro-switch is broken or out of adjustment, and causes the cocking motor to run continually during 2 cycles. At the third one, the machine decocks and the motor stops running.

The "PULL" button is stuck, or the cable is damaged.

4. ABNORMAL NOISES

Check all bolts for tightness.

The mainspring does not have sufficient tension on it, and the coils are touching each other: **it is imperative that when the spring is totally loose, the coils do not touch.** If they do, this could break the main body.

The gearbox is low on oil.

The one way bearing is worn out or damaged.

5. THE TARGETS BREAK IMMEDIATELY WHEN FIRING

The targets were damaged prior to loading.

The targets were damaged during loading.

Mixed targets (different diameters in it stack i.e. 107-109-110mm)

The rubber is damaged or worn.

The throwing arm is bent. It can be straightened without removing it. Check that the rubber is always at the same distance from the throwing plate. Uncock the throwing arm and take out the mainspring before this inspection and adjustment.

The throwing plate is damaged. Check edges of plate for 'nicks' and file smooth if necessary.

The throwing plate is dirty or has clay target pitch build up resulting in the target not being positioned correct at cocking time. Clean with solvent or sand it.

The throwing plate is loose.

Check that nothing is in the way of the target trajectory.

6. The motor starts turns but the machine does not cock.

Check the state of the chain.

7. The motor turns but the machine does not rotate.

Check the state of the chain, cable, and the spring.

8. Two clays fall from the magazine

Mixed clays (different diameters in same stack i.e. 107-109-110mm)

Check the distance between the clay and the clay block.

9. The targets do not come out of the magazine

The targets are stuck together. Separate them before putting them in the magazine.

Mixed targets. (Different diameters in same stack i.e. 107-109-110mm)

Magazine rods are damaged or bent and are restricting the vertical movement of the target stack.

The magazine support base is damaged.

The magazine is twisted.

The adapter knives are not adjusted correctly (see notice)

Check the distance between the clays and the clay block.

RECOMMENDED safety position when the machine is armed

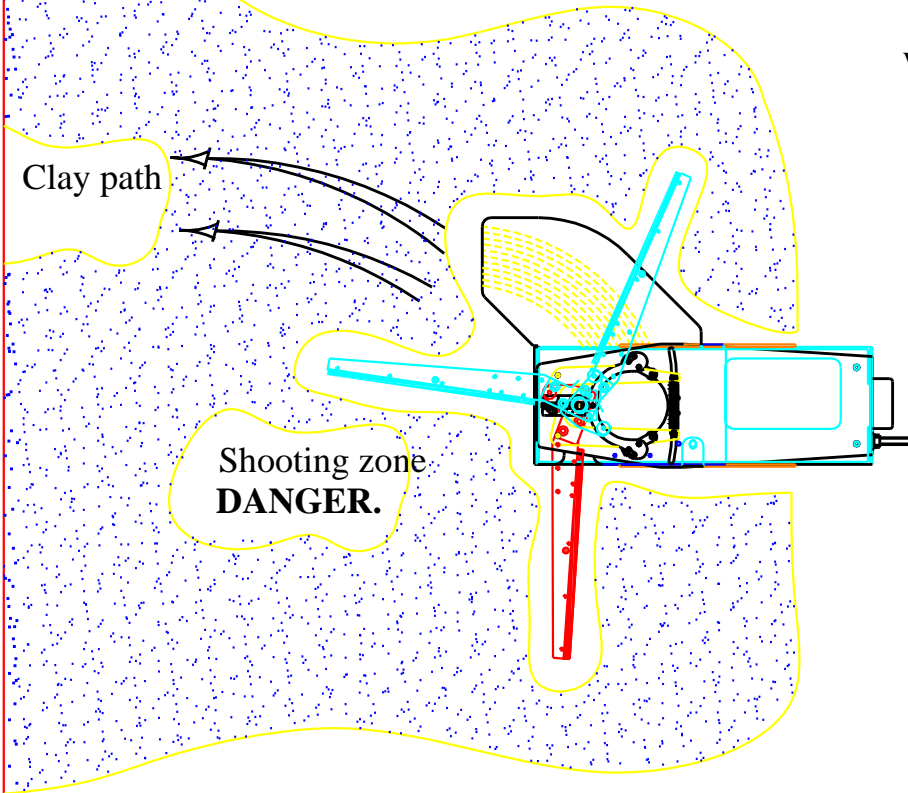

WARNING:
Do not unarm the machine
with an empty magazine.

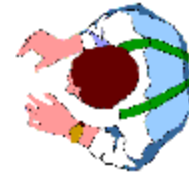

Throwing arm in armed and unarmed position.

Throwing arm in unarmed position:

Throwing arm in armed position:

WARNING DANGER !!!

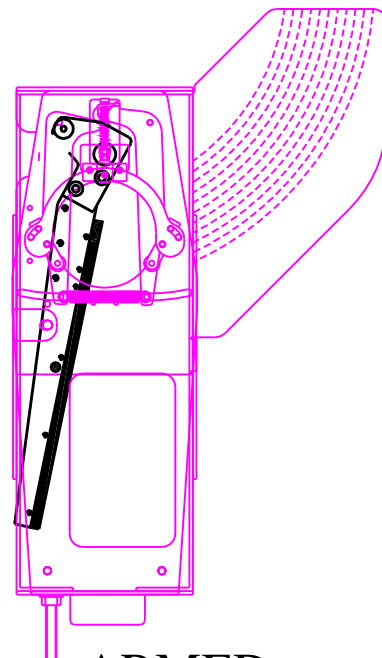
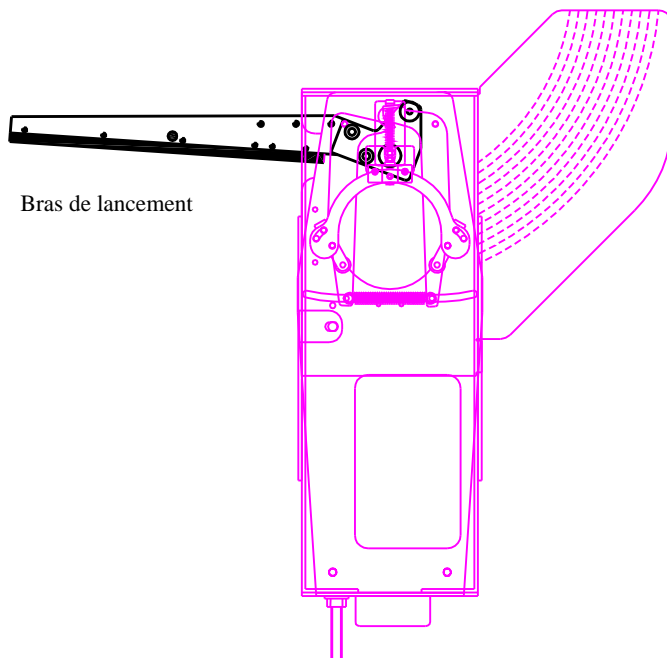

Arming Spring

Arm position when the machine is delivered:

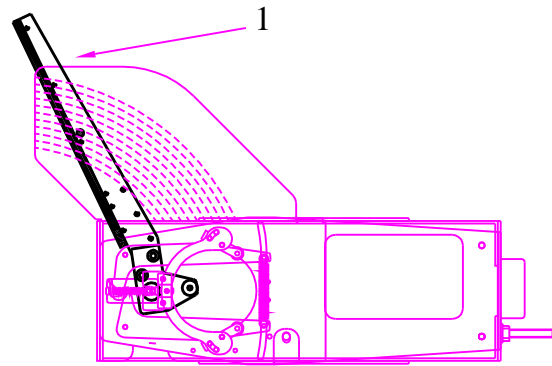
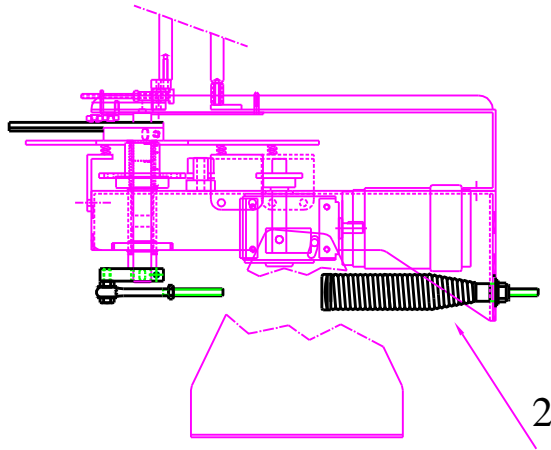

The throwing arm (1) is under the machine and the spring (2) is not connected.

1/ Position the arm in front of the mac

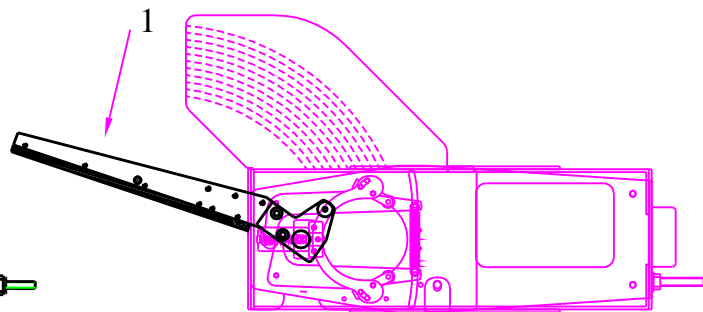
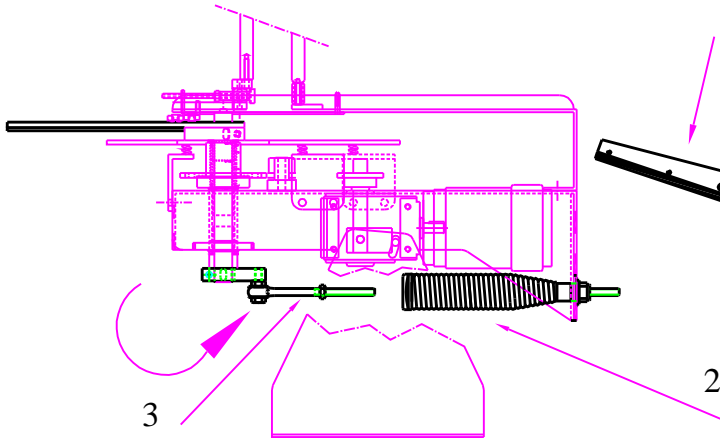

Pivot the arm (1) to position the threaded eye bolt (3) in the traction spring axes (2).
Tighten the spring (2) on the threaded eye bolt (3) by hand.

2/ Tighten the spring:

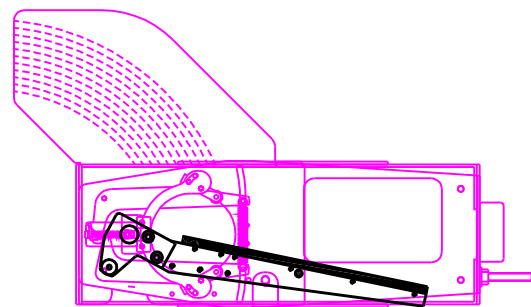
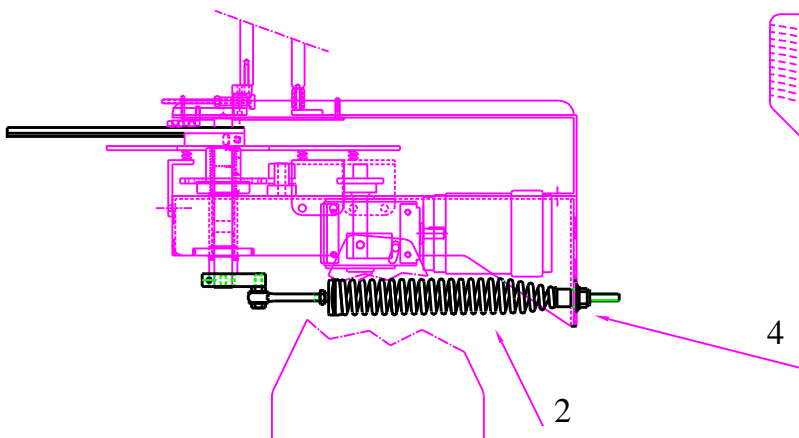

Scren the nut (4) up to tighten the spring (2).

Take off the spring:

- 1/ Unarm (By throwing a clay) and turn the machine OFF.
- 2/ Completely unscrew the nut (4).

-ASSEMBLY-OF-THE-SAFETY-GUARD

WARNING:-THROWING-ARM-IN-THE-UNARMED-POSITION
MACHINE-SWITCHED-OFF-FROM-THE-POWER-SUPPLY

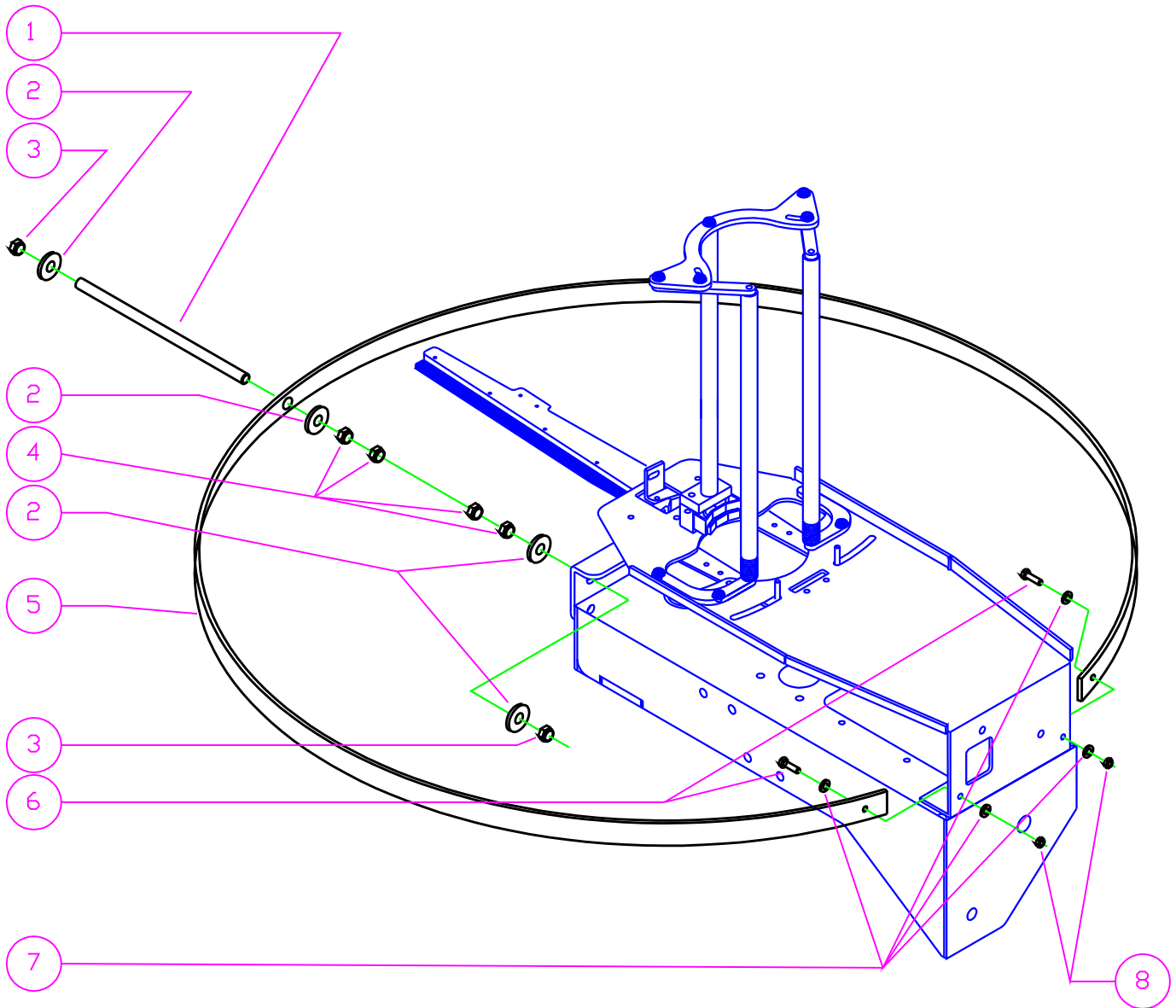

	QUANTITY	REFERENCE	DESCRIPTION
1	1	130	THREADED-ROD-12x500
2	4	1400050	WASHER M12
3	2	1400027	SELF-LOCKING-NUT-12
4	4	1400009	NUT-M-12
5	1	1307629	SAFETY-GUARD-TRAP-65
6	2	1400126	SCREW-TH-6x20
7	4	1400047	WASHER-M6
8	2	1400024	SELF-LOCKING-NUT-6

LAPORTE

Ce plan est la propriété de la Sté LAPORTE
371, chemin des Prés 06140 BIOT
Tel 04 93 66 77 98 Fax 04 93 66 77 99
et ne peut être reproduit ou communiqué sans son autorisation

LAPORTE BALL-TRAP

A.S.01/03

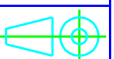

-MAGAZINE-ASSEMBLT- -TO-THROW-STANDARD-CLAYS-110-

WARNING: THROWING-ARM-IN-UNARMED--POSITION

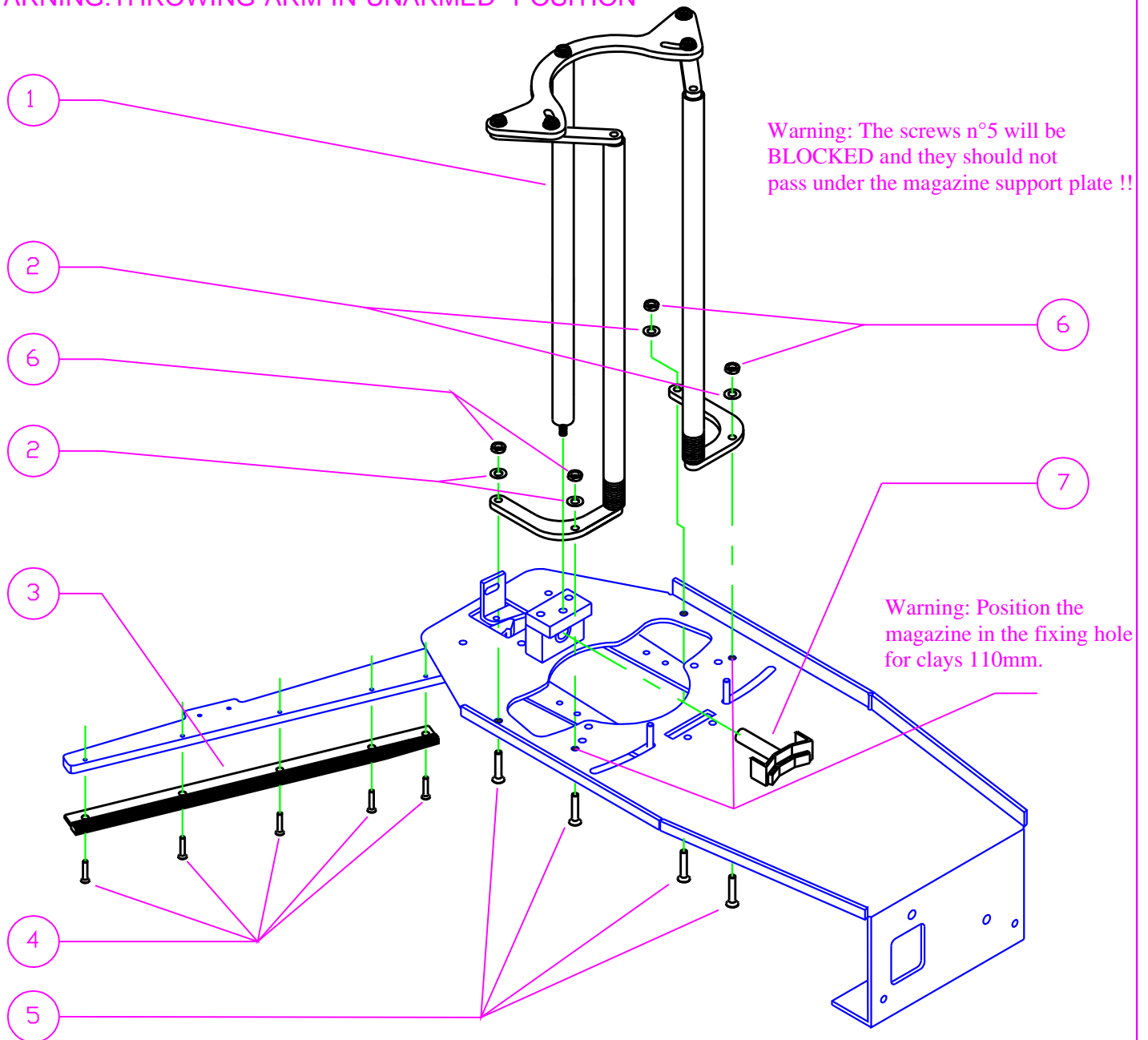

	QUANTITY	REFERENCE	DESCRIPTION
1	1	-	MAGAZINE TRAP 65
2	4	1400047	WASHER M6
3	1	1307601	STAND. CLAY RUBBER TRAP 65
4	5	1400343	SCREW TFHC M5x12
5	4	1400208	SCREW TFHC M6x25
6	4	1400024	SELF LOCKING NUT M6
7	1	1307637	CLAY BLOCK TRAP 65

LAPORTE

Ce plan est la propriété de la Sté LAPORTE
371, chemin des Prés 06140 BIOT
Tel 04 93 66 77 98 Fax 04 93 66 77 99
et ne peut être reproduit ou communiqué sans son autorisation

LAPORTE BALL-TRAP

A.S.01/03

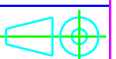

-MAGAZINE-ASSEMBLY- -FOR-BATTUE-CLAYS

WARNING-THROWING-ARM-IN-UNARMED-POSITION

IDENTICAL-SET-UP-AS-FOR
STANDARD-CLAY

Warning: Position the magazine in the holes for clays 110mm.

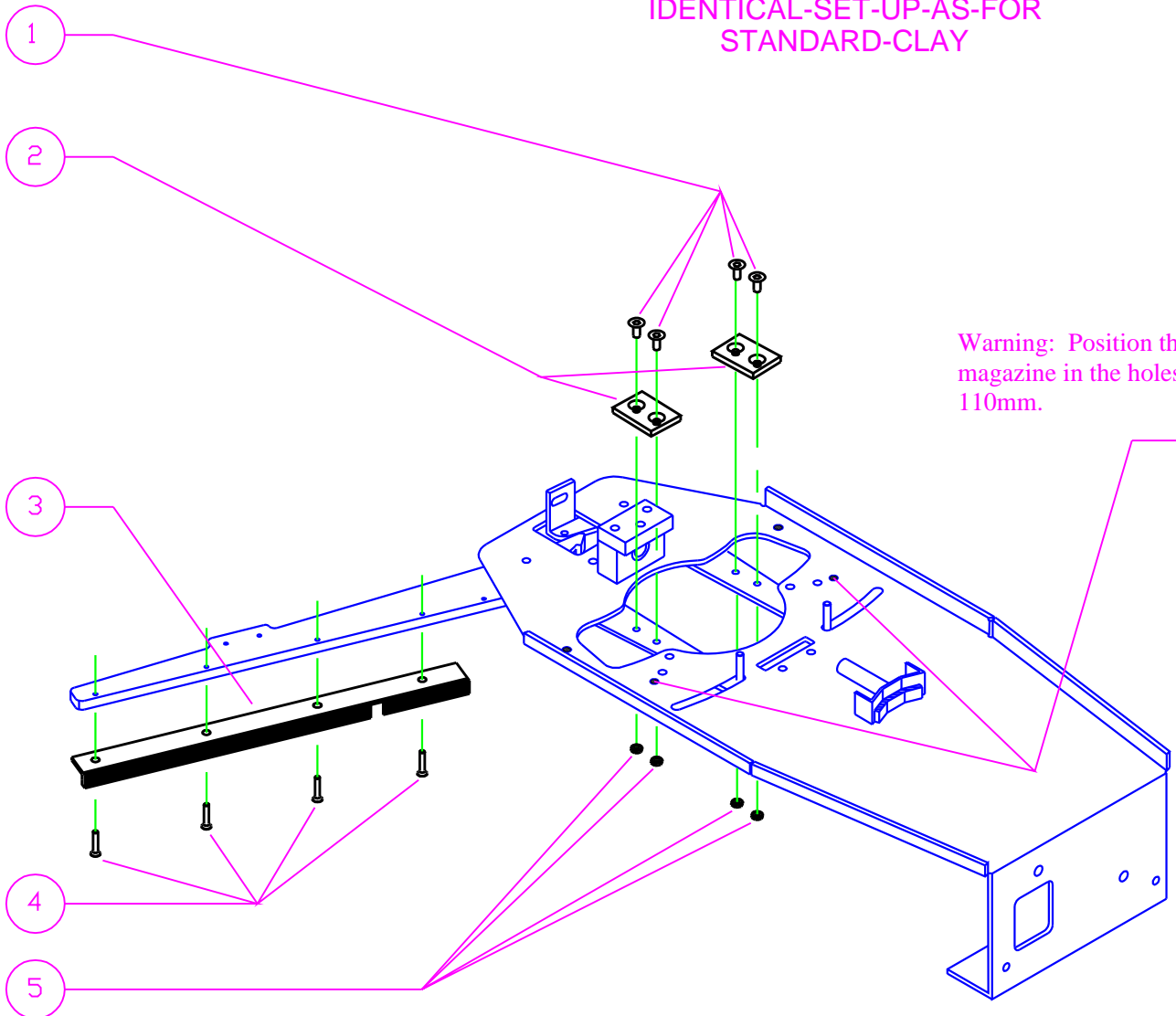

	QUANTITY	REFERENCE	DESCRIPTION
1	4	1400343	SCREW TFHC M5x12
2	2	1307638	BATTUE PLATE TRAP 65
3	1	1307603	BATTUE RUBBERTRAP 65
4	4	1400172	SCREW TCHC M5x10
5	4	1400023	SELF LOCKING NUT M5



Ce plan est la propriété de la Sté LAPORTE
371, chemin des Prés 06140 BIOT
Tel 04 93 66 77 98 Fax 04 93 66 77 99
et ne peut être reproduit ou communiqué sans son autorisation

LAPORTE BALL-TRAP

A.S.01/03



-MAGAZINE-ASSEMBLY- -FOR-MIDI-CLAYS-90-MM

WARNING-THROWING-ARM-IN-UNARMED-POSITION

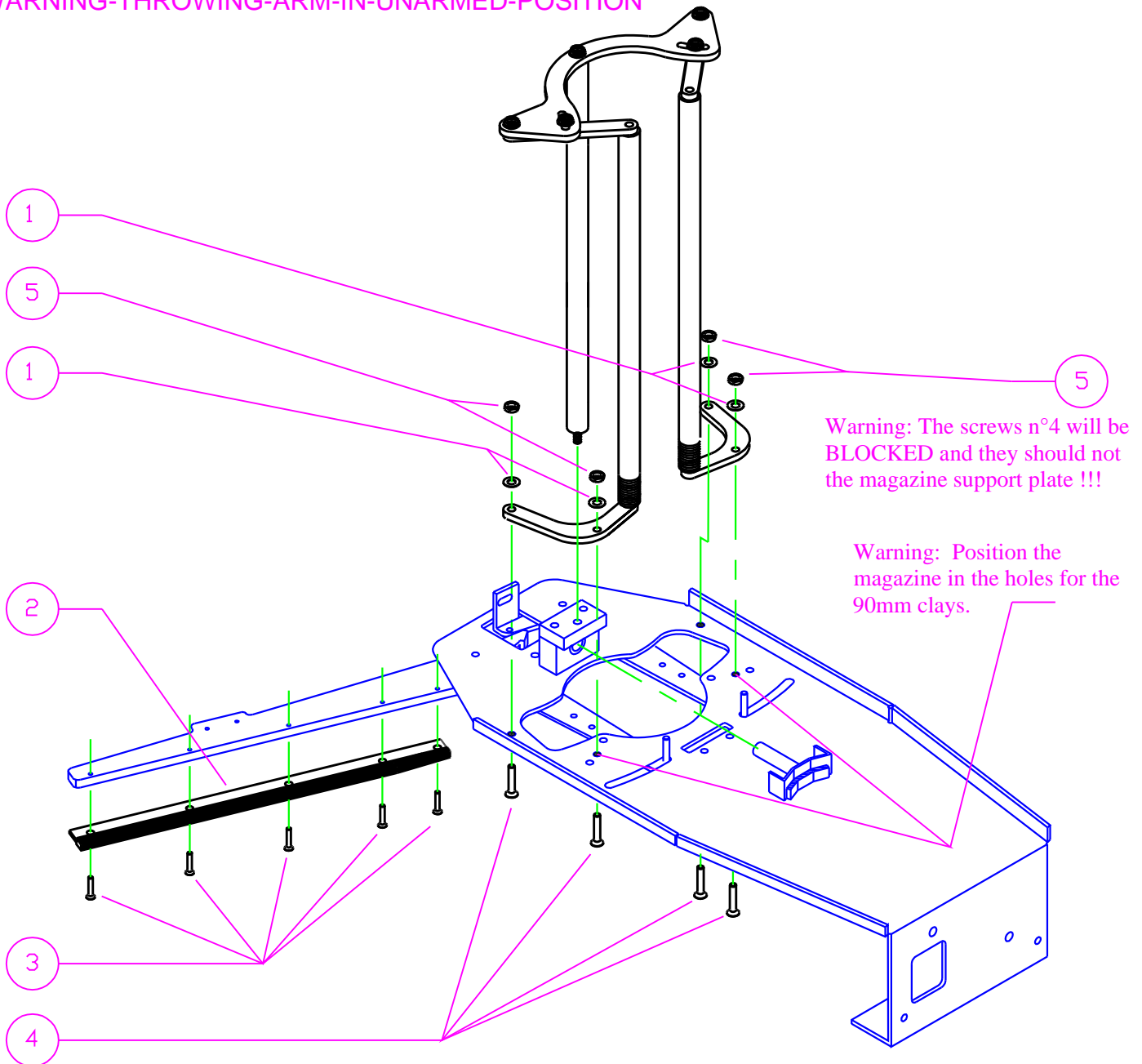

	QUANTITY	REFERENCE	DESCRIPTION
1	4	1400047	WASHER M6
2	1	1307601	STANDARD RUBBER TRAP 65
3	5	1400343	S CREW TFHC M5x12
4	4	1400208	SCREW TFHC M6x25
5	4	1400024	SELF LOCKING NUT M6



Ce plan est la propriété de la Sté LAPORTE
371, chemin des Prés 06140 BIOT
Tel 04 93 66 77 98 Fax 04 93 66 77 99
et ne peut être reproduit ou communiqué sans son autorisation

LAPORTE BALL-TRAP

A.S.01/03

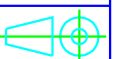

-MAGAZINE-ASSEMBLY- -FO-MINI-60-MM-CLAYS-----1/2

WARNING-THROWING-ARM-IN-UNARMED-POSITION

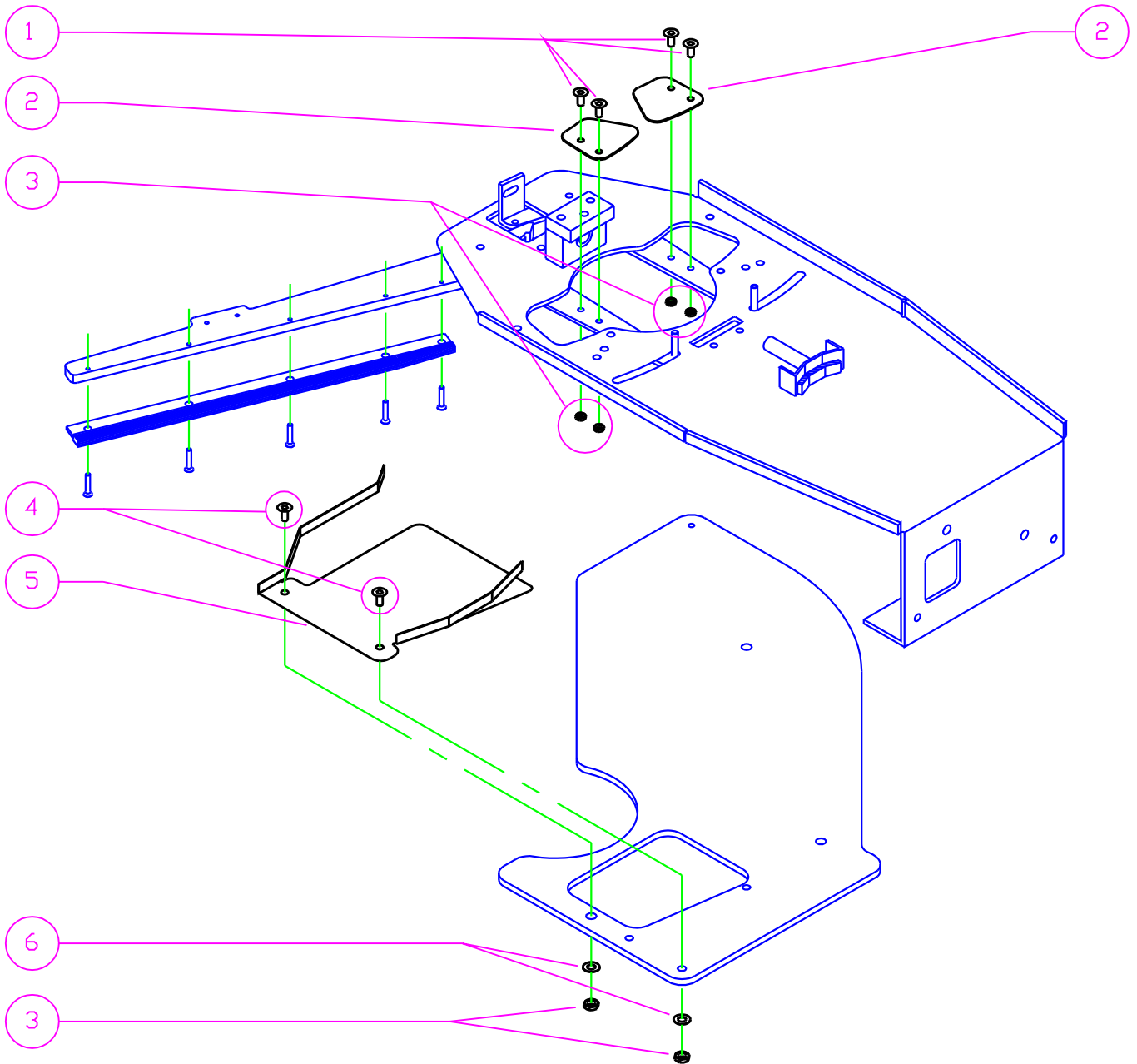

REPERE	QUANTITY	REFERENCE	DESCRIPTION
1	4	1400343	SCREW TFHC M5x12
2	2	1307621	60 PLATE TRAP 65
3	6	1400023	SELF LOCKING NUT M5
4	4	1400204	SCREW TFHC M5x16
5	4	1307656	SHOCK ABSORB. PLATE 60MM
6	2	1400046	WASHER M5
7			
8			

LAPORTE

Ce plan est la propriété de la Sté LAPORTE
371, chemin des Prés 06140 BIOT
Tel 04 93 66 77 98 Fax 04 93 66 77 99
et ne peut être reproduit ou communiqué sans son autorisation

LAPORTE BALL-TRAP

A.S.01/03

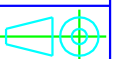

-MAGAZINE-ASSEMBLY- -FOR-MINI-60-MM-CLAYS-----2/2

WARNING-THROWING-ARM-IN-UNARMED-POSITION

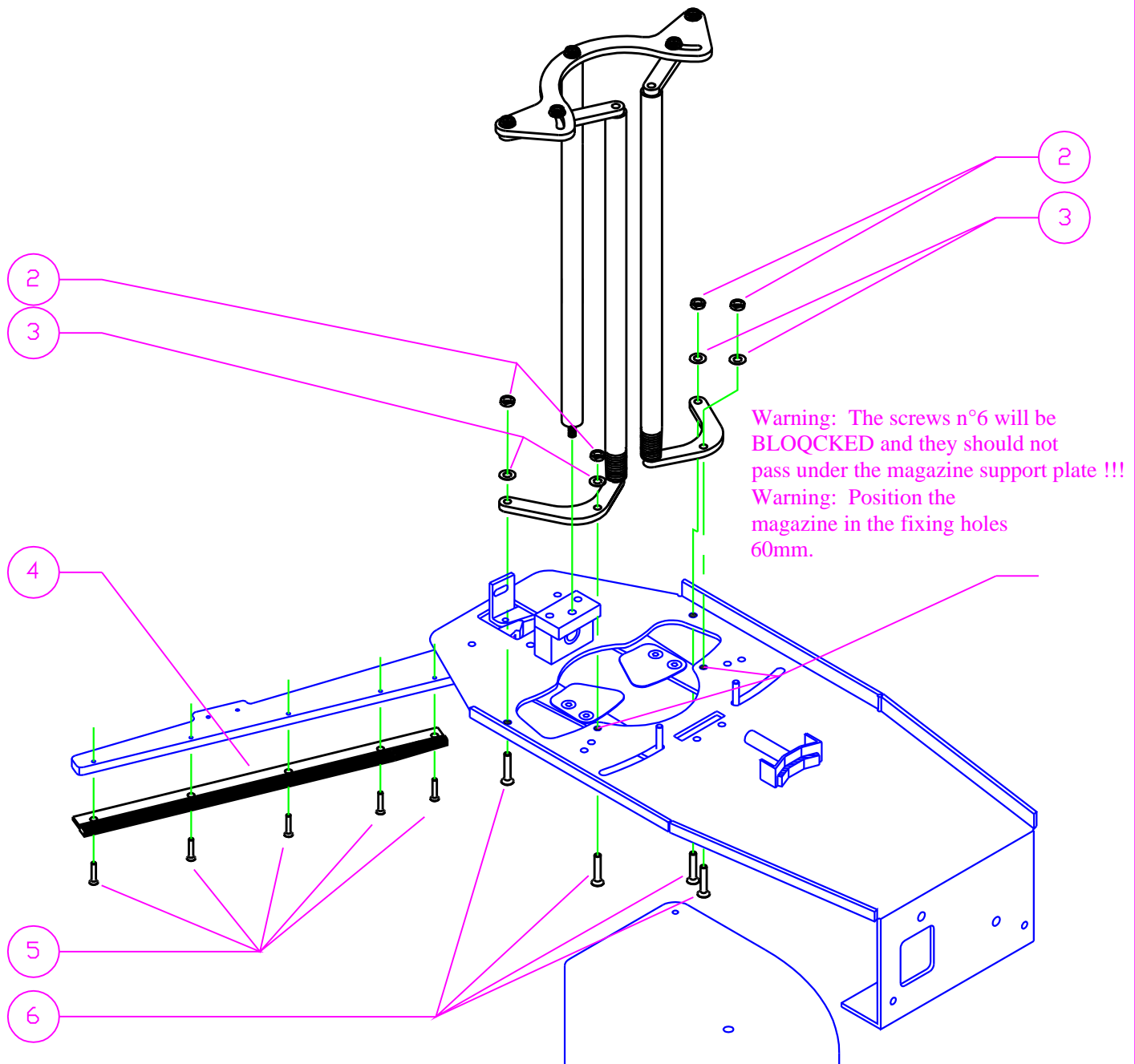

	QUANTITY	REFERENCE	DESCRIPTION
1			
2	4	1400024	SELF LOCKING NUTM6
3	4	1400047	WASHER M6
4	1	1307601	STANDARD RUBBER TRAP 65
5	5	1400343	SCREW TFHC M5x12
6	4	1400208	SCREW TFHC M6x25

LAPORTE

Ce plan est la propriété de la Sté LAPORTE
371, chemin des Prés 06140 BIOT
Tel 04 93 66 77 98 Fax 04 93 66 77 99
et ne peut être reproduit ou communiqué sans son autorisation

LAPORTE BALL-TRAP

A.S.01/03

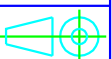

Moulded electronic box.

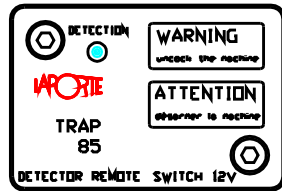

Electronic sensor.

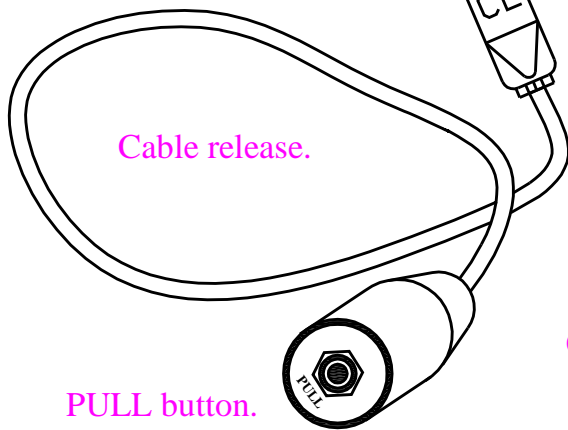

Cable release.

PULL button.



ON-OFF-UNCOCK switch.

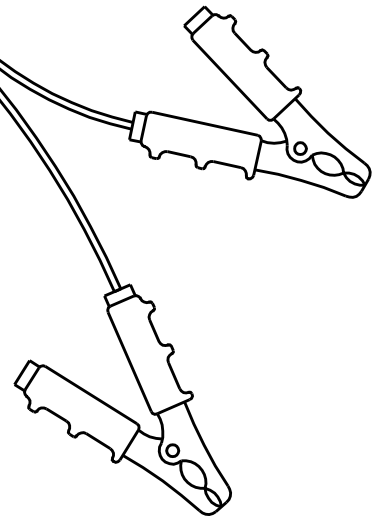

Power supply clips for the battery.

ON-OFF-UNCOCK button:



ON position:
Machine switched on.



OFF position:
Machine switched off.



UNCOCK position:
To unarm the machine.

Adjustment of the throwing plate.

- 1/ **Unarm** and switch the machine off.
 - 2/ It is **essential** to dismantle the arming spring. See arming spring notice.
 - 3/ Place a clay on the throwing plate.
 - 4/ Position the throwing arm (manually) level with the first adjustment screw.
 - 5/ Tighten the 13mm nut to obtain a spacing of less than 1 mm between the rubber and the clay.
(Unscrew the nut no:1 to reduce the space and tighten to increase.)
 - 6/ Repeat steps 4 and 5 for screws 2 and 3.
- Spacing recommended by the manufacturer, valid for all types of clays.

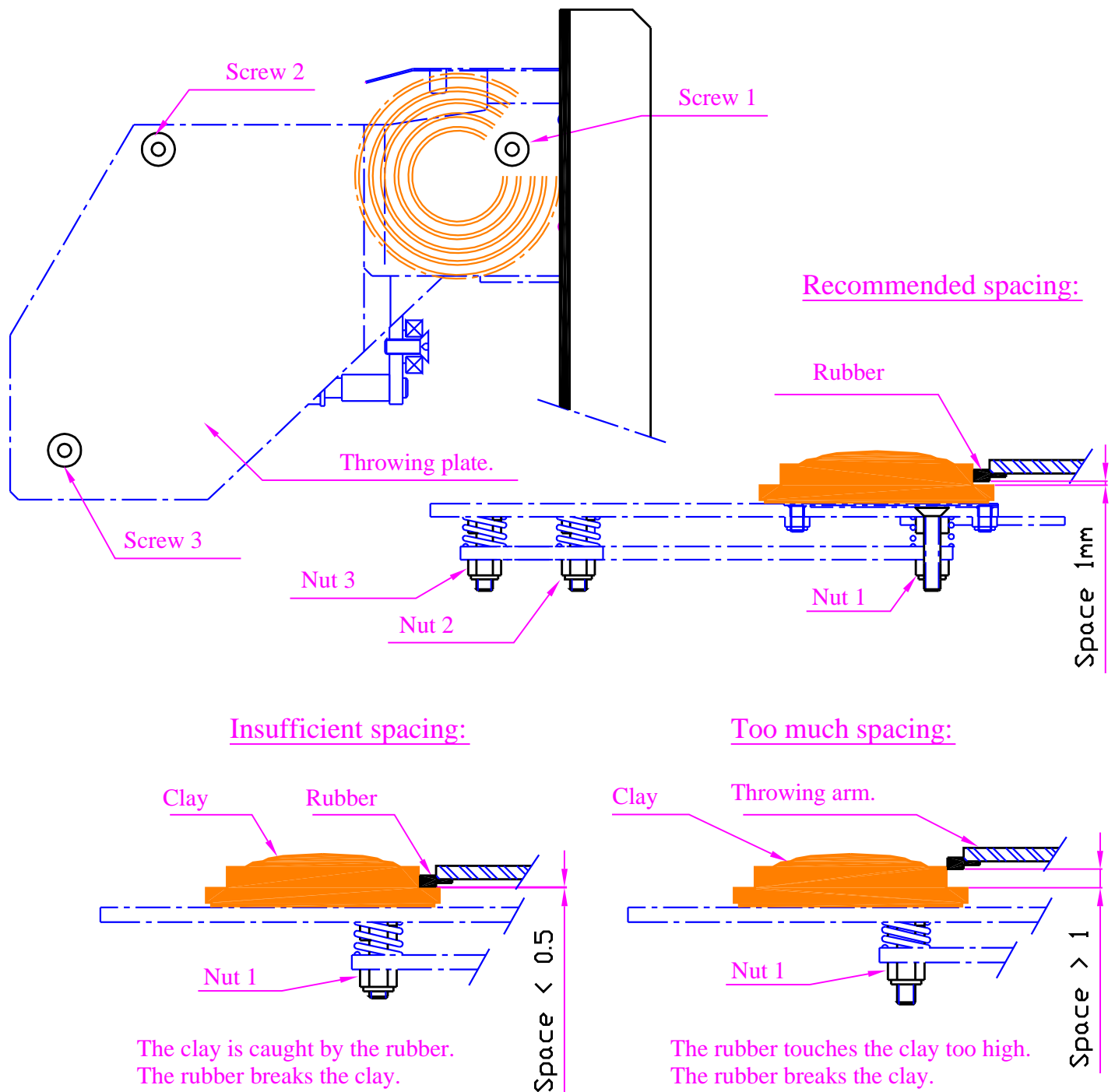

1-MAGAZINE-SUPPORT-PLATE-ASSEMBLY-

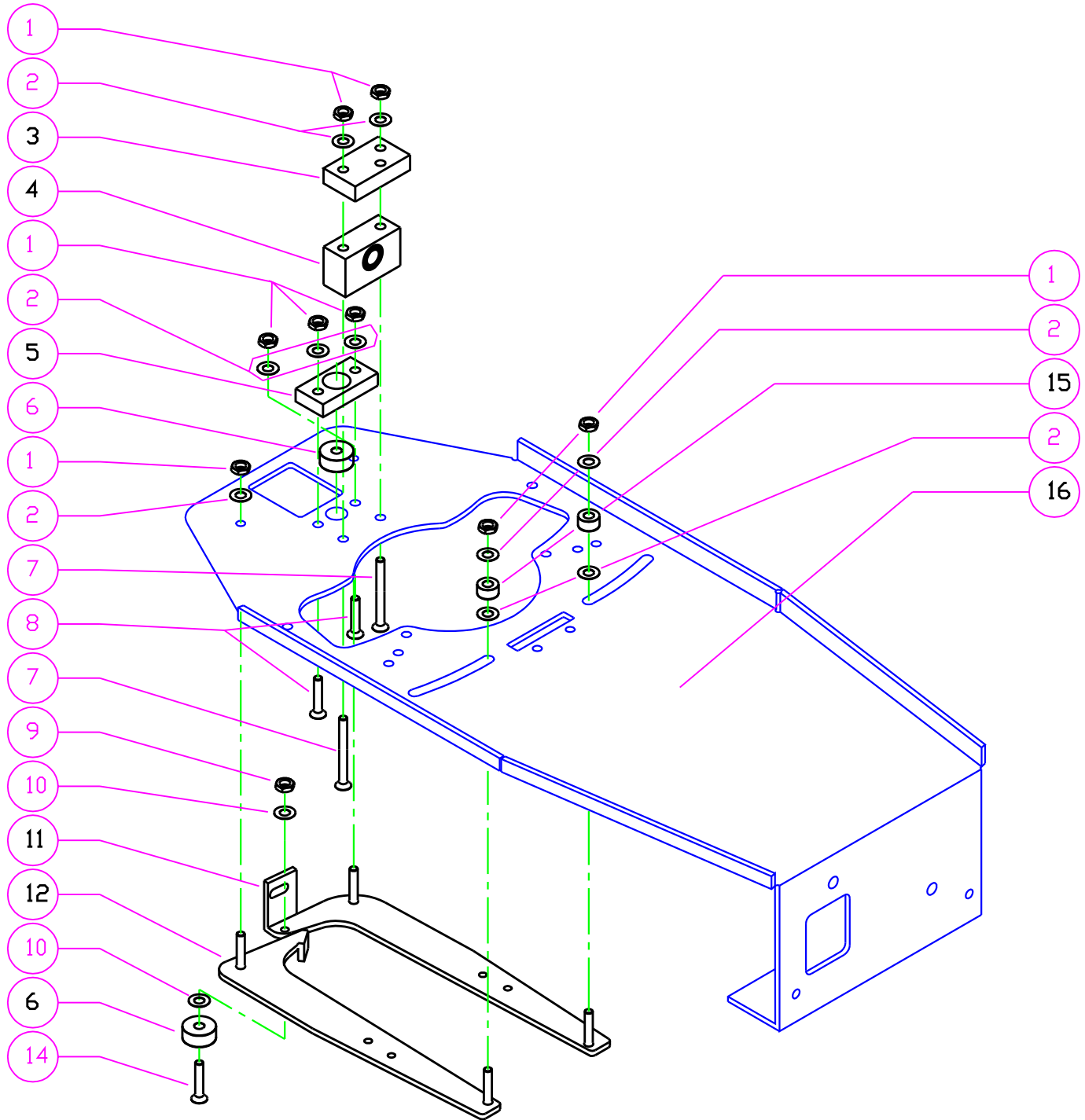

QUANTITY	REFERENCE	DESCRIPTION	QUANTITY	REFERENCE	DESCRIPTION
1	8	1400024	12	1	1307623
		SELF LOCKING NUT M6			LEFT HAND JAW TRAP65
2	10	1400047	14	1	1400205
		WASHER M6			SCREW TFHc M5x20
3	1	1307635	15	2	1111090
		MAG SUP ROD FRONT TRAP65			CABLE BUSHING 125
4	1	1307634	16	1	1307620
		CLAY SUPPORT BLOCK TRAP65			MAG SUPPORT PLATE TRAP65
5	1	1307636			
		CENTERING SQUARE TRAP65			
6	2	1307598			
		BEARING.608 EE 8x22x7			
7	2	1400323			
		SCREW TH M6x60			
8	2	1400208			
		SCREW TFHc M6x25			
9	1	1400023			
		SELF LOCKING NUT INDES M5			
10	2	1400023			
		WASHER M5			
11	1	1307622			
		RIGHT HAND JAW TRAP65			

LAPORTE

Ce plan est la propriété de la Sté LAPORTE
 371, chemin des Prés 06140 BIOT
 Tel 04 93 66 77 98 Fax 04 93 66 77 99
 et ne peut être reproduit ou communiqué sans son autorisation

LAPORTE BALL-TRAP

A.S.01/03

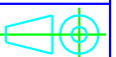

2-MAGAZINE-SUPPORT-PLATE-ASSEMBLY-

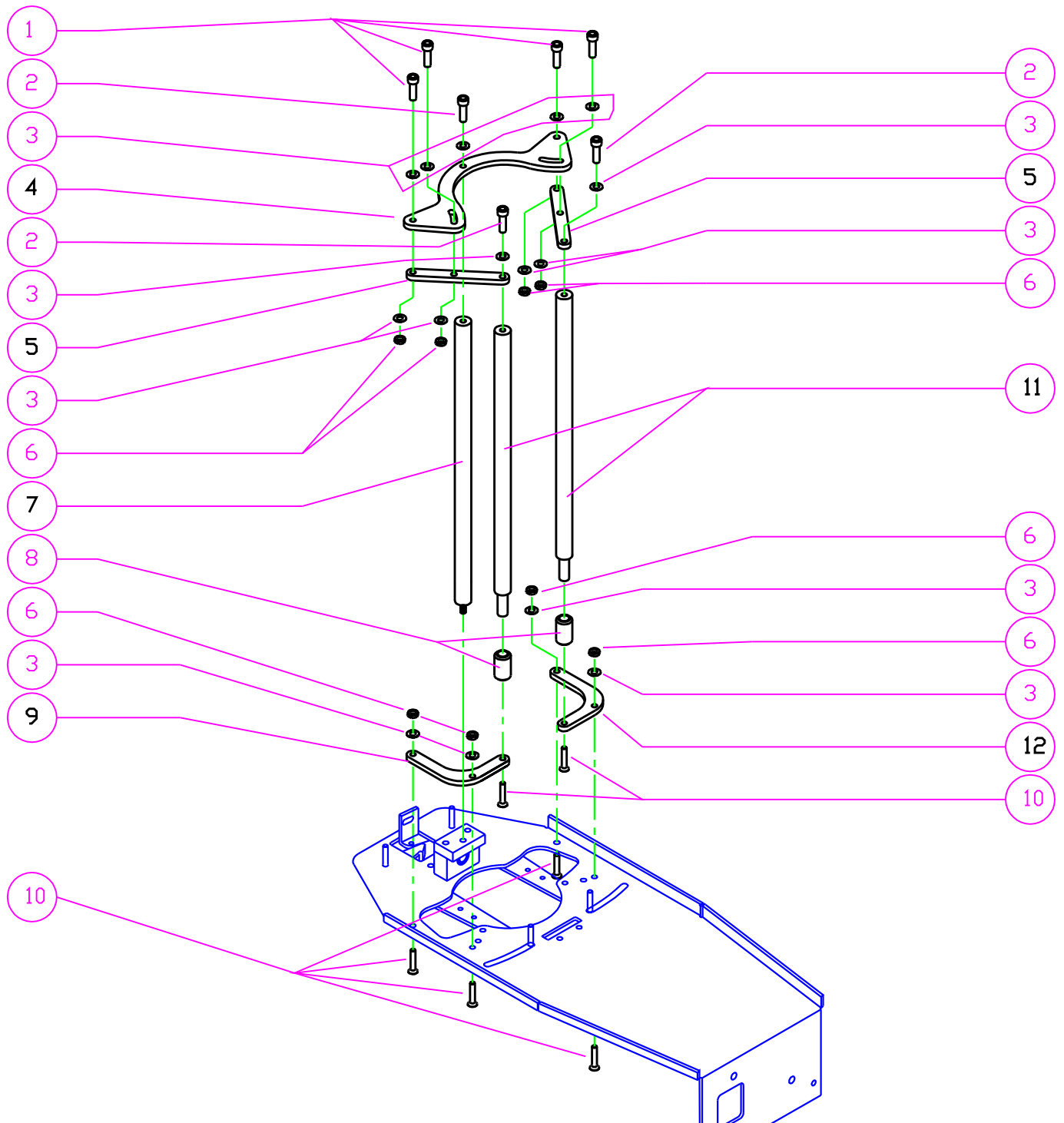

	QUANTITY	REFERENCE	DESCRIPTION		QUANTITY	REFERENCE	DESCRIPTION
1	4	1400128	SCREW TH M6x30	12	1	1307618	MAGAZINE ROD PLATE Dr T. 65
2	3	1400126	SCREW TH M6x20				
3	15	1400047	WASHER-M6				
4	1	1307616	MAGAZINE PLATE TRAP 65				
5	2	1307617	ROD TOP PLATE T. 65				
6	10	1400024	SELF LOCKING NUT M6				
7	1	1307632	MAGAZINE ROD TRAP 65				
8	2	1301385	MAGAZINE BLOCK 185-RAB				
9	1	1307619	MAGAZINE ROD PLATE Ga T. 65				
10	6	1400208	SCREW TFHc M6x25				
11	2	1307633	MAGAZINE ROD REAR TRAP 65				

LAPORTE

Ce plan est la propriété de la Sté LAPORTE
 371, chemin des Prés 06140 BIOT
 Tel 04 93 66 77 98 Fax 04 93 66 77 99
 et ne peut être reproduit ou communiqué sans son autorisation

LAPORTE BALL-TRAP

A.S.01/03

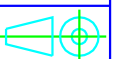

3-MAGAZINE-SUPPORT-PLATE-ASSEMBLY-

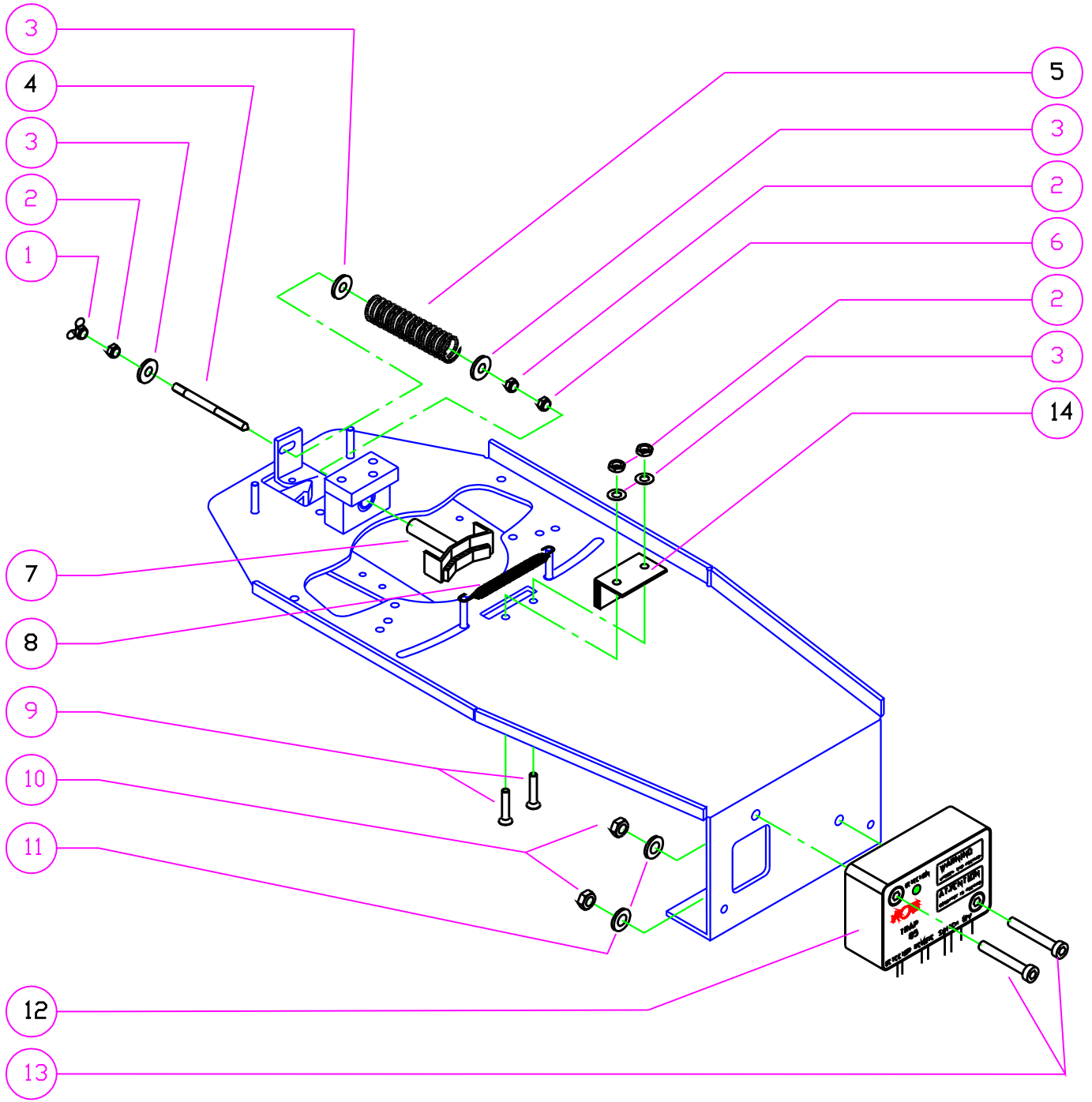

QUANTITY	REFERENCE	DESCRIPTION	QUANTITY	REFERENCE	DESCRIPTION	
1	1400029	WING NUT M6	12	1	1150600	MOULDED ELECT. BOX 12V
2	1400024	SELF LOCKING NUT M6	13	2	1400338	SCREW TCHc M8x50
3	1400047	WASHER-M6	14	1	1307649	CLAY HOLDING BRUSH
4	1307648	ADJUSTING SPINDLE TRAP 65				
5	1307382	COMPRESSION SPRING 14 T 85				
6	1400002	NUT HU M6				
7	1307637	CLAY BLOCK TRAP 65				
8	1307383	TRACTION SPRING 13 TRAP 85				
9	1400125	SCREW TH M6x16				
10	1400025	SELF LOCKING NUT M8				
11	1400048	WASHER M8				

LAPORTE

Ce plan est la propriété de la Sté LAPORTE
 371, chemin des Prés 06140 BIOT
 Tel 04 93 66 77 98 Fax 04 93 66 77 99
 et ne peut être reproduit ou communiqué sans son autorisation

LAPORTE BALL-TRAP

A.S.01/03

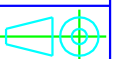

4-BODY

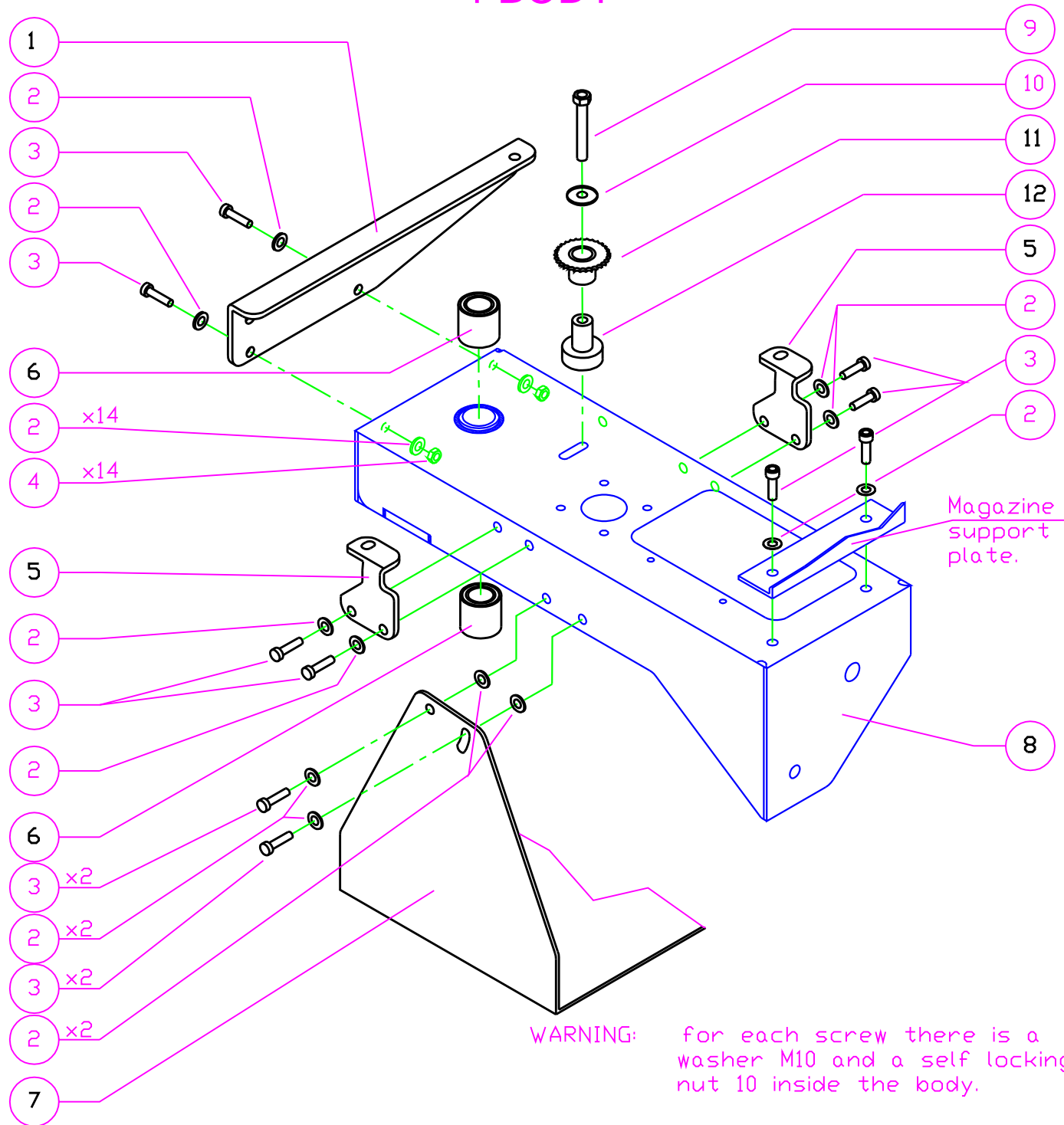

WARNING: for each screw there is a washer M10 and a self locking nut 10 inside the body.

	QUANTITY	REFERENCE	DESCRIPTION		QUANTITY	REFERENCE	DESCRIPTION
1	1	1307627	ANGLE CLEAT THRO. PLATE FR.	12	1	1307645	TENSION SPACER T65
2	30	1400049	WASHER M10				
3	12	1400148	SCREW TH M10x30				
4	14	1400026	SELF LOCKING NUT M10				
5	2	1307625	ANGLE CLEAT THRWING PLATE				
6	2	1307597	NEEDLE BEARING HK 2538 T65				
7	1	1307630	TRAP BASE 65				
8	1	1307631	TRAP BODY 65				
9	1	1400153	SCREW TH M10x70				
10	1	1400055	LARGE WASHER 10				
11	1	1307132	PIGNON TENDEUR TRAP 85				

LAPORTE

Ce plan est la propriété de la Sté LAPORTE
371, chemin des Prés 06140 BIOT
Tel 04 93 66 77 98 Fax 04 93 66 77 99
et ne peut être reproduit ou communiqué sans son autorisation

LAPORTE BALL-TRAP

A.S.01/03

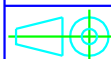

6-BODY

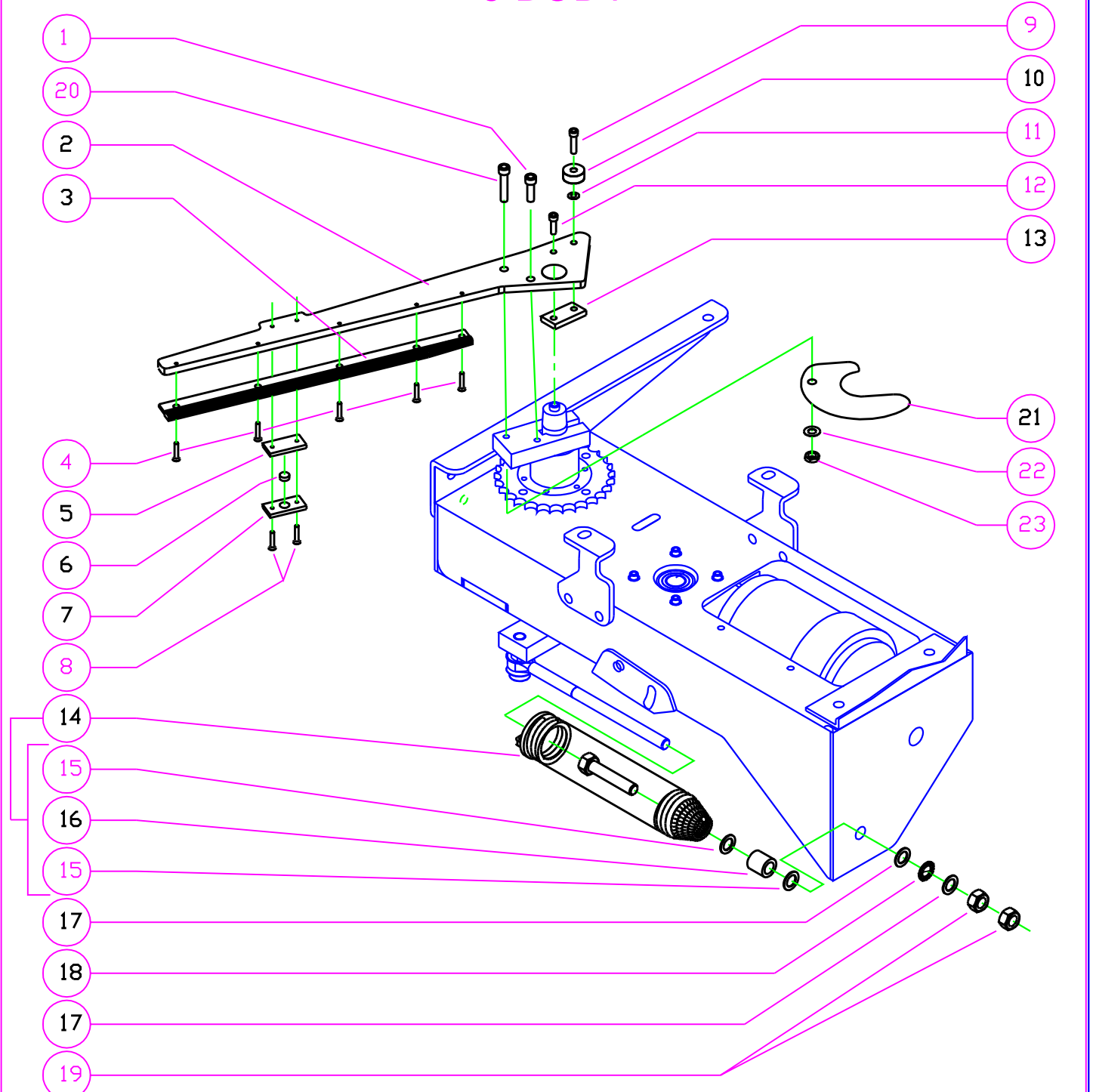

QUANTITY	REFERENCE	DESCRIPTION	QUANTITY	REFERENCE	DESCRIPTION		
1	1400209	SCREW TFHc M8x20	13	1	1307639	ARM REINFORCEMENT PLATE	
2	1307624	THROWING ARM T65	14	1	1304850	ARMING SPRING GREEN CPLT	
3	1307601	STANDARD RUBBER T65	15	2	1400050	WASHER M12	
4	5	1400343	SCREW TFHc M5x12	16	1	1302340	SHOCK ABS SPRING 75-2001
5	1307096	MAGNET SUPPORT BLOCK T85	17	2	1302255	BLOCK WASHER AS 1226 75-185	
6	1306410	AIMANT 10x4	18	1	1300690	NEEDLE BLOCK AXK 1226 125	
7	1307530	MAGNET SUPPORTT T85	19	2	1400009	NUT HU M12	
8	2	1400204	SCREW TFHc M5x16	20	1	1400211	SCREW TFHc M8x40
9	1400208	SCREW TFHc M6x25	21	1	1307640	DROP PROT. ADAPTER L2 T65	
10	1307608	BEARING 607 EE 7x19x6 T65	22	1	1400048	WASHER M8	
11	1400047	WASHER M6	23	1	1400025	SELF LOCKING NUT M8	
12	1400319	SCREW TFHc M6x16					

LAPORTE

Ce plan est la propriété de la Sté LAPORTE
 371, chemin des Prés 06140 BIOT
 Tel 04 93 66 77 98 Fax 04 93 66 77 99
 et ne peut être reproduit ou communiqué sans son autorisation

LAPORTE BALL-TRAP

A.S.01/03

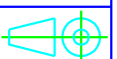

7-BODY

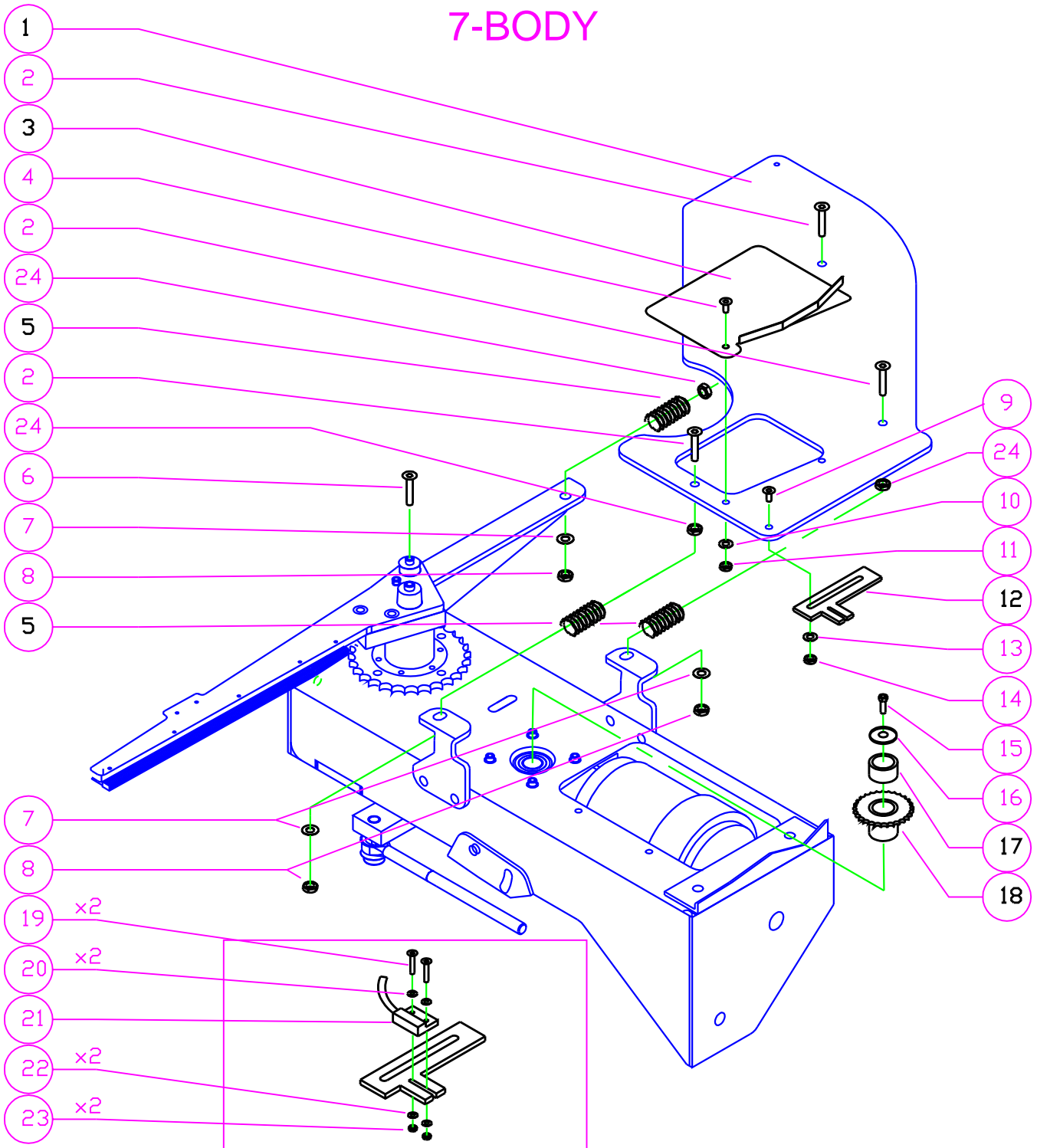

QUANTITY	REFERENCE	DESCRIPTION	QUANTITY	REFERENCE	DESCRIPTION	
1	1307626	THROWING PLATE TRAP65	13	1400047	WASHER M6	
2	1400316	SCREW TFHc M8x50	14	1400024	SELF LOCKING NUT M6	
3	1307628	SHEET METAL SHOCK ABSO.	15	1400124	SCREW TH M6x12	
4	1400204	SCREW TFHc M5x16	16	1400314	LARGE WASHER M6	
5	1305120	BASE SPRING 185	17	1307647	SPACER T65	
6	1400207	SCREW TFHc M6x20	18	1307207	PIGNON MOTEUR ARM. T85	
7	1400048	WASHER M8	19	1400419	SCREW TC M3x16	
8	1400025	SELF LOCKING NUT M8	20	1400058	WASHER M3 EVENT.	
9	1400208	SCREW TFHc M6x25	21	MOULDED ELECTRONIC BOX SENSOR		
10	1400046	WASHER M5	22	1400044	WASHER M3	
11	1400023	SELF LOCKING NUT M5	23	1400435	SELF LOCKING NUT M3	
12	1307097	SUPPORT CAPTEUR T85	24	3	1400003	NUT HU M8

LAPORTE

Ce plan est la propriété de la Sté LAPORTE
 371, chemin des Prés 06140 BIOT
 Tel 04 93 66 77 98 Fax 04 93 66 77 99
 et ne peut être reproduit ou communiqué sans son autorisation

LAPORTE BALL-TRAP

A.S.01/03

